

SELECTOR ACTUATORS

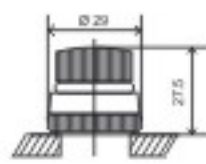

Symmetric Head Non Illuminated

Cat. No.	: 2 Position
Non Spring Return	HK65C□
Spring Return	HI65C□
	3 Position
Non Spring Return	HL65C□
Spring Return	HJ65C□
Spring Return L.H.	HM65C□
Spring Return R.H.	HN65C□
Colour (6th Digit)	: 1 2 3 5

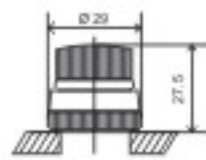

Symmetric Head Illuminated

Cat. No.	: 2 Position
Non Spring Return	HK66C□
Spring Return	HI66C□
	3 Position
Non Spring Return	HL66C□
Spring Return	HJ66C□
Spring Return L.H.	HM66C□
Spring Return R.H.	HN66C□
Colour (6th Digit)	: 1 2 5 8

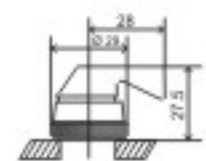

Lever Head Non Illuminated

Cat. No.	: 2 Position
Non Spring Return	HK75C□
Spring Return	HI75C□
	3 Position
Non Spring Return	HL75C□
Spring Return	HJ75C□
Spring Return L.H.	HM75C□
Spring Return R.H.	HN75C□
Colour (6th Digit)	: 1 3 5

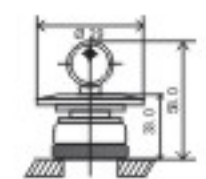

Lock & Key Rotary Type Non Illuminated**

Cat. No.	: 2 Position
Non Spring Return	HK85C3
Spring Return	HI85C3
	3 Position
Non Spring Return	HL85C3
Spring Return	HJ85C3
Spring Return L.H.	HM85C3
Spring Return R.H.	HN85C3
Colour (6th Digit)	: 3

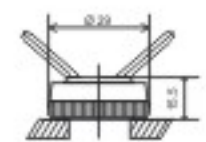



Tip Head Non Illuminated

Cat. No.	: HP95C□
Colour (6th Digit)	: 1 2 3 5



Lock & Key Push Turn

Cat. No.	: HH85C3
Colour (6th Digit)	: 3

Note*: In 2 position selector actuator, for operating style  replace 2nd digit from K to R and for operating style  replace 2nd digit from K to T.

** For Lock & Key Actuators, various combinations for Key removal Positions are available i.e. Left, Right or Both.

Note: Colours available (Except Lock & Key)-
1 - Red, 2 - Green, 3 - Black, 4 - Yellow,
5 - White/Opal, 6 - Blue, 7 - Orange, 8 - Colourless

2 POSITION

3 POSITION

